

THIS DRAWING IS UNPUBLISHED. RELEASED FOR PUBLICATION 20
 © COPYRIGHT 20 BY TYCO ELECTRONICS CORPORATION. ALL RIGHTS RESERVED.

LOC	DIST	REVISIONS					
DF	X0	P	LTR	DESCRIPTION	DATE	DWN	APVD
		A		RELEASED	22JAN2008	CT	DW
		B		REVISED PER ECO-11-003614	22FEB2011	RJM3	DW

COMPONENT	MATERIAL	FINISH
HOUSING COUPLING NUT	STAINLESS STEEL PER ASTM-A484 AND ASTM-A582, TYPE 303	GOLD PLATE PER ASTM B-488
DIELECTRIC	PTFE FLUOROCARBON PER ASTM-D-1457	N/A
CENTER CONTACT	BERYLLIUM COPPER PER ASTM B 196, ALLOY C17300, CONDITION H OR BRASS PER ASTM-B-16	GOLD PLATE PER ASTM B-488
RETAINING RING	BERYLLIUM COPPER PER ASTM B 194, ALLOY C17200, CONDITION H	N/A
GASKET	SILICONE RUBBER PER ZZ-R-765	N/A

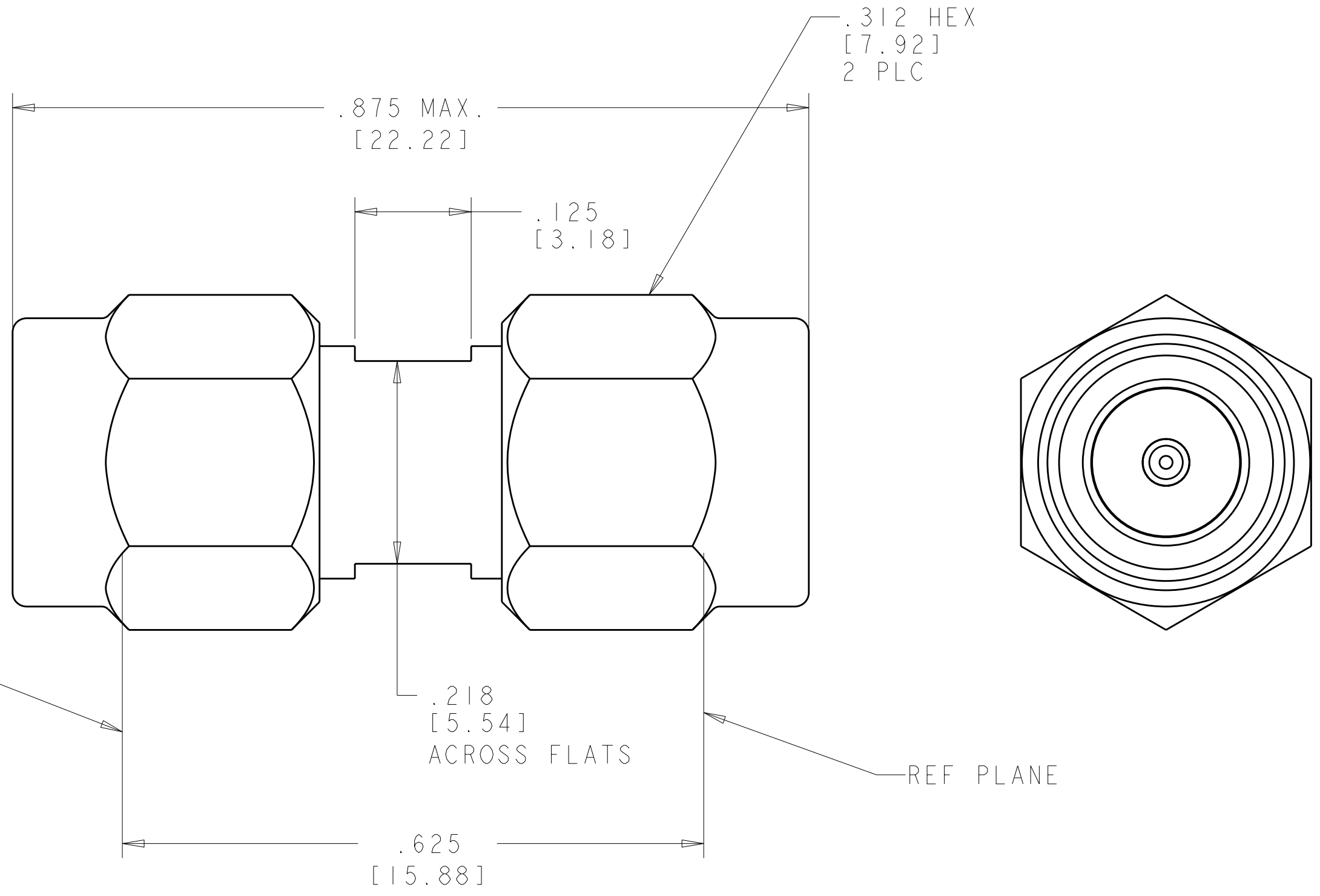

I. ABSOLUTE INSERTION PHASE PER TABLE AND A TEMPERATURE OF +25°C.

ELECTRICAL	MECHANICAL	ENVIRONMENTAL
Nominal Impedance (Ohms) <u>50</u>	Interface Dimensions MIL-STD-348A FIG 310.1	TEMPERATURE RATING <u>-65°C TO 165°C</u>
Frequency Range (GHz) <u>DC to 3.0</u>	Recommended Mating Torque <u>7.0 to 10.0 In/Lbs</u>	Vibration - MIL-STD-202, Method 204, Condition D
Volt Rating (VRMS MAX) <u>335</u>	Connector Engagement <u>2.0 In/Lbs MAX</u>	Shock - MIL-STD-202, Method 213, Condition I
VSWR <u>1.08 + .005f(GHz) MAX</u>	Center Contact Captivation Axial <u>6 Lbs MIN</u>	Thermal shock MIL-STD-202, Method 107 Test Condition C
Insertion Loss (dB MAX) <u>.06 √f(GHz)</u>	Radial <u>N/A</u>	Moisture Resistance - MIL-STD-202, Method 106, except Step 7b
RF Leakage <u>-[90-f(GHz)]</u>	Weight (Grams) <u>4.7</u>	(Vibration) shall be omitted
Corona, 70,000 Ft (VRMS MIN) <u>250</u>		Corrosion - MIL-STD-202, Method 101, Condition B, 5% salt spray
Dielectric Withstanding Voltage (VRMS MIN) <u>1000</u>		
Contact Resistance (Milliohms MAX) Center Contact <u>4.0</u> Outer Contact <u>2.0</u>		
RF High Potential (VRMS MIN @ 5 MHz) <u>670</u>		
I.R. (Megohms) <u>5,000</u>		

.850	-27°±0.5°@1.0GHz	1996352-1
.875	-24°±0.5°@1.0GHz	1996352-2
DIM. "A"	INSERTION PHASE	PART NO.

THIS DRAWING IS A CONTROLLED DOCUMENT FOR TYCO ELECTRONICS CORPORATION. IT IS SUBJECT TO CHANGE AND THE CONTROLLING ENGINEERING ORGANIZATION SHOULD BE CONTACTED FOR THE LATEST REVISION.

DIMENSIONS: INCHES [mm]	TOLERANCES UNLESS OTHERWISE SPECIFIED:	DWN <u>C.C. THOMAS</u> 22JAN2008	Tyco Electronics Harrisburg, PA 17105-3608
	0 PLC ±- 1 PLC ±- 2 PLC ±- 3 PLC ±.005 [0.13] 4 PLC ±- ANGLES ±- FINISH	CHK <u>D. WILSON</u> 22JAN2008 APVD <u>D. WILSON</u> 22JAN2008	
MATERIAL SEE TABLE	SEE TABLE	PRODUCT SPEC - APPLICATION SPEC - WEIGHT SEE TBL	NAME <u>SMA PLUG TO PLUG ADAPTER, PHASE MATCHED</u>
		CUSTOMER DRAWING	SIZE <u>A200779</u> CAGE CODE <u>C-1996352</u> DRAWING NO <u>1996352</u> RESTRICTED TO -
		SCALE <u>8:1</u>	SHEET <u>1</u> OF <u>1</u> REV <u>B</u>